

# HOW TO MAKE A POT PLANT HOLDER

## INSTRUCTIONAL GUIDE

### TOOLS REQUIRED

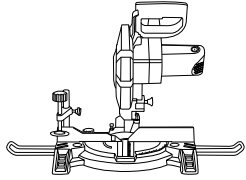

Compound Mitre Saw



18V Cordless Drill Driver



18V Cordless Jigsaw

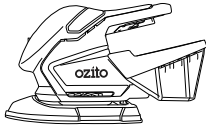

18V Cordless Detail Sander

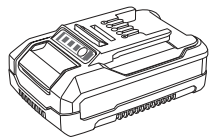

18V Battery Pack

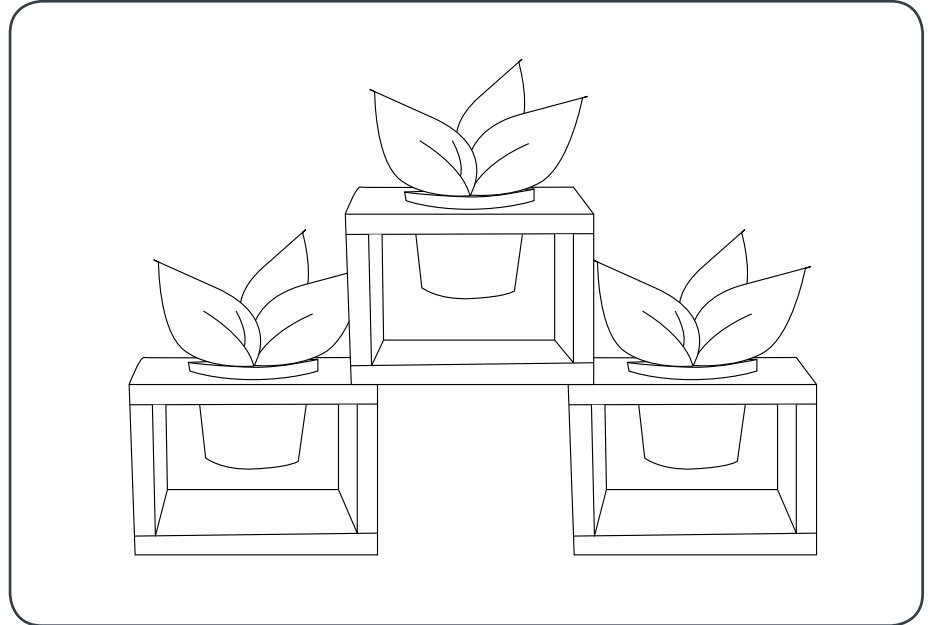

### CUT LIST:

Cut 2 lengths at 120mm for sides

Cut 2 lengths at 220mm for top & bottom

### SAFETY TIPS:

Please ensure that any loose clothing, hair, lanyards, etc. are secured and cannot make contact with tools while in use.

Wait until all tools are completely stopped before resting the tool on the bench.

Ensure all personal safety equipment is used suitable to the application.

If you are unsure of how to use any of the tools listed ask someone who has the knowledge before attempting to use the product.

Please also refer to the product manual for usage instructions and tips.

### WHAT YOU'LL NEED

#### Timber:

1 x Dressed Pine: 140 x 19 x 1200mm

#### Fasteners:

8 x 40mm Screws (8-10g)

#### Accessories:

1 x 6mm Timber Drill Bit

1 x 3mm Timber Drill Bit

1 x Pencil

1 x PH2 Driver Bit (Phillips Head)

1 x Tape Measure

1 x 80 Grit Sandpaper

1 x Jigsaw Blade

1 x Compass

4 x Workbench Clamps

#### Safety Equipment:

Safety glasses & ear protection



For full safety precautions for each tool please refer to product manuals.

## Set Up

Check the width and length of the timber you're using will suit the height and width of the pot. Dimensions can be adjusted to suit.

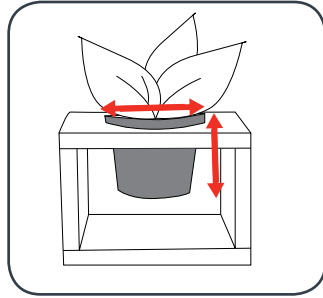

- 1 Measure 220mm from one end of the length of timber board and mark a line. Using a mitre saw cut along the marked line.

Repeat this step to create 2 x 220mm lengths & 2 x 120mm lengths.

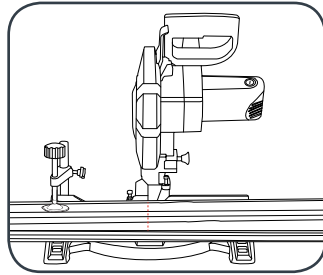

- 2 Clamp timber pieces together with the longer lengths making the top and smaller lengths making the sides.

Using the drill driver with 3mm drill bit, drill pilot holes through the top and bottom pieces into the sides.

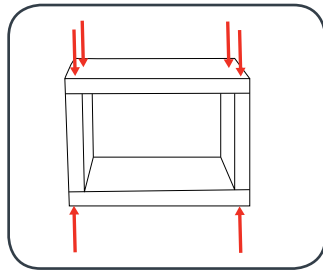

- 3 Swap the drill bit for the PH2 bit. Using the 40mm screws, screw the sides of the plant holder together.

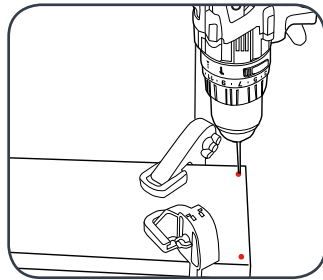

- 4 Measure the size of the rim on your pot plant, if this is the same size as the base then trace around the base in the centre of the top piece.

If the rim is larger than the base of the plant use a compass to create a circle the same size as the rim in the centre of the top piece. Check out our video for a cool tip on how to make your own compass.

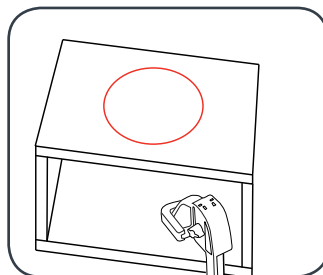

- 5 With a 6mm drill bit on the drill, create a hole on the inside edge of the circle.

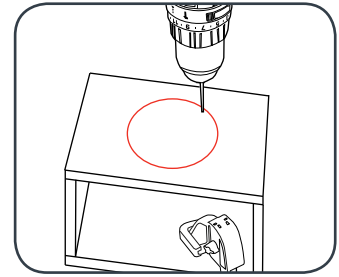

- 6 Insert the blade of the jigsaw into the 6mm hole. Ensure the base plate of the jigsaw is flat on the timber surface and slowly cut around the marked circle. You may need to re-clamp the plant holder to the bench in a different position to complete the cut.

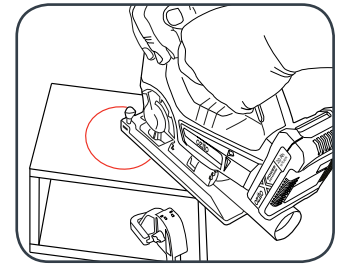

- 7 Clean up any rough edges on the timber with a sander.

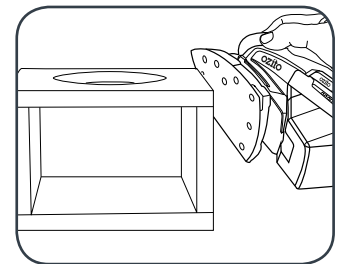

## Finishing Touches

Place your pot with plant into the hole and you're done! For more effect, create additional pieces of the holder to stack them together. You can protect the timber with a coat of paint or varnish.

